



TEST REPORT

Report No.: F8970.02-109-44

Rendered to:

VELUX America LLC
Greenwood, South Carolina

PRODUCT TYPE: Skylight

SERIES/MODEL: Dynamic Dome Skylight Polycarbonate Smooth (5' x 10') (0.150 thickness)

SPECIFICATION(S): Occupational Safety and Health Administration/U.S. Department of
Labor Regulations (Standards- 29 CFR) - 1910.23(e) (8)

California Code of Regulations, Title 8, Section 3212

Test Date(s): 07/29/16

Report Date: 01/09/18

Test Record Retention Date: 07/29/20

- 1.0 Report Issued To:** VELUX America LLC
1418 Evans Pond Road
P.O. Box 5001
Greenwood, South Carolina 29648-5001
- 2.0 Test Laboratory:** Architectural Testing, Inc., an Intertek company ("Intertek-ATI")
130 Derry Court
York, Pennsylvania 17406-8405
717-764-7700
- 3.0 Project Summary:**
- 3.1 Product Type:** Skylight
- 3.2 Series/Model:** Dynamic Dome Skylight Polycarbonate Smooth (5' x 10') (0.150 thickness)
- 3.3 Compliance Statement:** Results obtained are tested values and were secured by using test method(s) intended to address the designated performance specifications.
- 3.4 Test Date(s):** 07/29/16
- 3.5 Test Record Retention End Date:** All test records for this report will be retained until July 29, 2020.
- 3.6 Test Location:** Intertek-ATI test facility in York, Pennsylvania.
- 3.7 Test Specimen Source:** The test specimen(s) was provided by the client. Representative samples of the test specimen(s) will be retained by Intertek-ATI for a minimum of two years from the test completion date.
- 3.8 Drawing Reference:** The test specimen drawings have been reviewed by Intertek-ATI and are representative of the test specimen(s) reported herein. Test specimen construction was verified by Intertek-ATI per the drawings located in Appendix B. Any deviations are documented herein or on the drawings.
- 3.9 List of Official Observers:**

<u>Name</u>	<u>Company</u>
Timothy J. McGill	Intertek-ATI
Richard E. Hartman III	Intertek-ATI

4.0 Test Method (intended to address listed specification(s)):

Occupational Safety and Health Administration/U.S. Department of Labor Regulations (Standards- 29 CFR) - 1910.23(e) (8)

California Code of Regulations, Title 8, Section 3212

A 400 lb. weight, fabricated from a bag filled with lead shot, was placed on the center of the screen for a minimum of 60 seconds. The bag was removed and the test unit was inspected for any signs of damage or failure.

Additional Loading:

The specimen was taken to failure using sandbags placed on the center of the screen for a minimum of 60 seconds. The highest load causing penetration or damage was recorded.

5.0 Test Specimen Description:

Intertek Building & Construction (B&C) was contracted by VELUX America LLC, 1418 Evans Pond Road on December 4, 2017 to evaluate the OSHA fall protection testing to the most recent referenced document. Occupational Safety and Health Administration (OSHA)/U.S. Department of Labor Regulations Standard 29 CFR §1910.29 – Fall protection systems and falling object protection-criteria and practices. Section 1910.29(e)(1) requires a cover to be capable of supporting without failure at least twice the maximum intended load that may be imposed on the cover at any one time.

Intertek Building & Construction (B&C) was contracted by VELUX America LLC, 1418 Evans Pond Road on December 4, 2017 to evaluate the Cal/OSHA fall protection testing to the most recent referenced document. California Code of Regulations, Title 8, Section 3212 §(b), which states, "covers shall be capable of safely supporting the greater of 400 lbs or twice the weight of the employees, equipment and materials that may be imposed on any one square foot area of the cover at any time."

6.0 Test Specimen Description:

6.1 Product Sizes:

Overall Area: 57.5 ft ²	Width (inches)	Height (inches)
Overall size	65-3/4	126

6.2 Frame Construction:

Frame Member	Material	Description
Inner frame	Aluminum	Extruded
Dome clamp cover	Aluminum	Extruded

	Joinery Type	Detail
All corners	Mitered	Miter cut and welded

6.3 Reinforcement: No reinforcement was utilized

6.4 Weatherstripping:

Description	Quantity	Location
Custom shaped gasket	1 row	Located around the interior perimeter of the inner frame

6.5 Glazing: No conclusions of any kind regarding the adequacy or inadequacy of the poly smooth in any glazed test specimen(s) can be made.

Glazing Type	Glazing Method
5/32" poly smooth	The glazing was set from the exterior onto a custom shaped gasket against the extruded aluminum frame. The glazing was secured using an aluminum extruded dome clamp cover with a bead of sealant on the glazing. The dome clamp cover was secured using #10 x 5/8" screws located 2" from all corners and 12" on center.

Location	Quantity	Daylight Opening (inches)	Glazing Bite (inches)
Dome	1	59-3/4 x 120	7/8

7.0 Installation: The specimen was installed into a Spruce-Pine-Fir wood buck.

Location	Anchor Description	Anchor Location
Aluminum frame	#10 x 1-1/2" pan head screw	8" from corners, 12" on center

8.0 Test Results: The results are tabulated as follows:

8.1 California (and OSHA) minimum loading:

Test Load	Load Location	Results
400 lbf	Center of dome	No visible damage

Note: The 400 lbf weight was gently applied perpendicular to the center of the dome. After 60 seconds of rest time, there was no visible damage to the glazing.

8.2 Additional loading (applied on the same unit in the listed order):

Test Load	Load Location	Results
509 lbf at rest	Center of dome	No visible damage
615 lbf at rest	Center of dome	No visible damage
722 lbf at rest	Center of dome	No visible damage
830 lbf at rest	Center of dome	No visible damage
943 lbf at rest	Center of dome	No visible damage
1053 lbf at rest	Center of dome	No visible damage
1166 lbf at rest	Center of dome	No visible damage
1275 lbf at rest	Center of dome	See Note #1

Note #1: At 1275 lbf, the load created on opening larger than one square foot.

9.0 Test Results: The results are tabulated as follows:

The specimen was evaluated in accordance with Occupational Safety and Health Administration (OSHA)/U.S. Department of Labor Regulations Standard 29 CFR §1910.29(e)(1) to be capable of supporting twice the maximum intended load, up to (583) ft-lb.

The specimen was evaluated in accordance with California Code of Regulations, Title 8, Section 3212 §(b) to be capable of safely supporting loads exceeding 400 ft-lb.

Intertek-ATI will service this report for the entire test record retention period. Test records such as detailed drawings, datasheets, representative samples of test specimens, or other pertinent project documentation, will be retained by Intertek-ATI for the entire test record retention period.

This report does not constitute certification of this product nor an opinion or endorsement by this laboratory. It is the exclusive property of the client so named herein and relates only to the specimen(s) tested. This report may not be reproduced, except in full, without the written approval of Intertek-ATI.

For ARCHITECTURAL TESTING, Inc.

Richard E. Hartman III
Technician

Timothy J. McGill
Manager – Product Testing

REH:asm/abo

Attachments (pages): This report is complete only when all attachments listed are included.

Appendix-A: Photograph(s) (1)

Appendix-B: Drawing(s) (15)

Appendix A
Photograph(s)



Photo No. 1
View of Tested Specimen



Photo No. 2
Test Specimen during 400 lb. Load

Appendix B

Drawing(s)

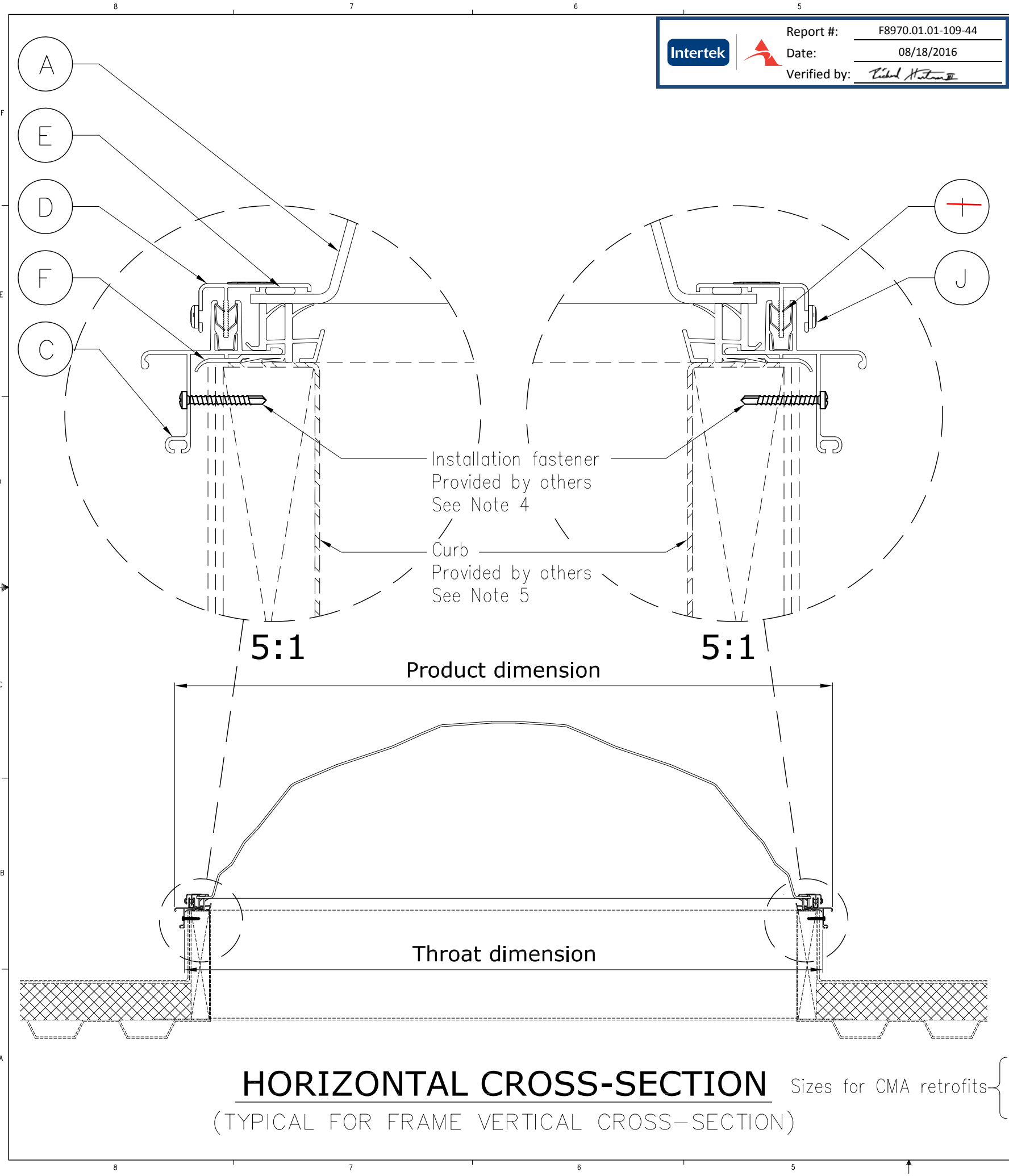

PART SCHEDULE									
ITEM	QTY.	PART	PART NO.	DESCRIPTION	DRAWING NO.				COMMENTS
					Category	Commodity No.	Operation	Edition	
A	1	Dynamic exterior dome	_____	Polycarbonate, or acrylic, or impact modified acrylic	21	3036150A03	20	02	Thermoformed exterior dome
C	4	Inner frame	302359	6063/T5 Aluminum Powder coat color: NCS S 7500–N (Grey)	21	3023590000	00	01	Profile
					21	3023590A03	10	02	Cutting and punching
					21	3023590A03	90	02	Powder coat
					21	3023590A04	20	02	Welding
N/A	N/A	Primer	N/A	Clamp cover, Inner Frame, & Domes	21	3023590A05	20	01	Primer placement
D	4	Dome clamp cover	302360	6063/T5 Aluminum Powder coat color: NCS S 7500–N (Grey)	21	3023610000	00	01	Profile
					21	3023610A03	10	02	Cutting and drilling
					21	3023610A03	90	02	Powder coat
					21	3023600A04	20	01	Welding
E	N/A	Commercial sealant	305660	Silicone for commercial application	21	3036600A05	20	02	Silicone placement
F	4	High profile gasket	303612	TPE Color: Black	21	3036120000	00	01	Profile
					21	3036110000	39	01	Gasket groove cutting
					21	3036110A03	10	01	Gasket cutting
					21	3036110A04	20	02	Gasket welding
H*	4	Gasket wick	305659	Polyethelene felt for wicking	21	3056590000	00	02	Profile/cutting
					21	3056590A05	20	02	Wick placement
I	#	Spring clip	306222	301 Spring Temper Stainless Steel	21	3062220000	00	01	
					21	3062220A05	20	02	Spring clip placement

FASTENER SCHEDULE									
ITEM	QTY.	PART	PART NO.	DESCRIPTION	DRAWING NO.				COMMENTS
					Category	Commodity No.	Operation	Edition	
J	#	Torx screw	306225	Torx Pan head, SST, #2 drill point #10-16x5/8"	21	3062250000	00	01	Commodity drawing

GENERAL NOTES

- * Not Visible in this drawing
- 1. Unless noted otherwise, all parts listed are for CD1, CE1, CT1, CG1, CH1, CJ1 Commercial Dome skylights.
- 2. A copy of this drawing plus any other supplemental documentation regarding this skylight model will be maintained at the Skylight Technical Database in the following category location – Technical Data/Submittal Data/
- 3. Horizontal and Vertical Frame Cross-Section part sizes, materials and assembly are identical.
- 4. #8 or larger stainless steel installation fasteners, appropriate for supporting structure. Provided by others. One fastener per hole of Inner frame.
- 5. The CDx skylight installs directly on site built or prefabricated curbs, provided by others.

Size	Throat dimension mm	Product dimension mm
2'	717	758
3'	1022	1063
4'	1326.5	1368
5'	1631.5	1672.5
6'	1936	1977.5
7'	2241	2282
8'	2546	2857
10'	3155.5	3197
225	743	784
305	946	987
345	1047.5	1088.5
465	1352.5	1393.5

VELUX America Inc.
CONFIDENTIAL

THIS DRAWING IS THE SOLE PROPERTY OF VELUX AMERICA INC. ANY REPRODUCTION IN PART OR AS A WHOLE WITHOUT THE WRITTEN PERMISSION OF VELUX AMERICA IS PROHIBITED.									
DIMENSIONS ARE IN MM GENERAL TOLERANCES: ANGULAR: ±1 ONE PLACE DECIMAL : ±0.5					NOTE:				
MATERIAL					VELUX				
SPECIFICATION					SKY-GPM 1418 Evans Pond Road PO Box 5001 Greenwood, South Carolina 29648-5001				
FINISH					Commercial Single Dome Skylight CD1, CE1, CT1, CG1, CH1, CJ1 Product Certification Typical Arrangement with Product List of Parts				
STANDARDS					REV. SCALE: CWD/DRAWN/DATE RLE/IDH 04/06/2016 SHEET 1 OF 1				

Edition	Description of change	Date
02	Added note	3/29/16

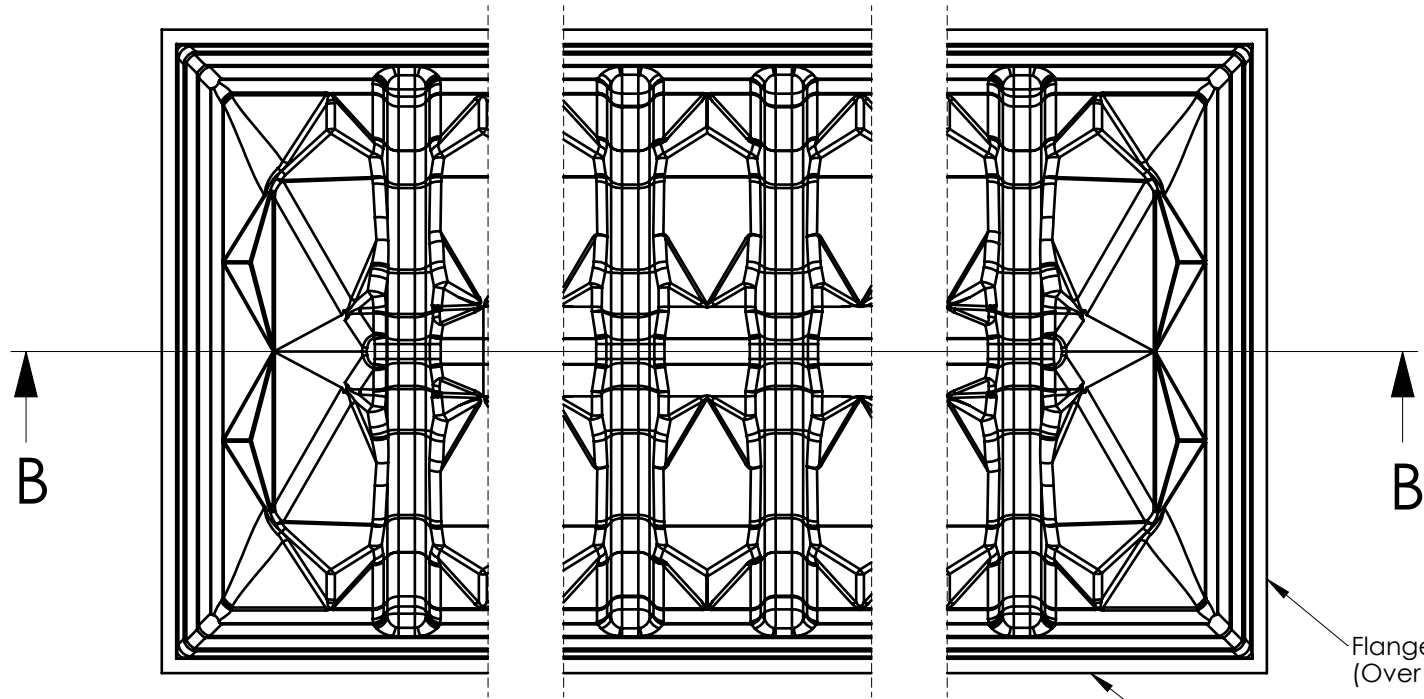

Flange straightness to ± 3.5 mm.
(Over 5' length)

Flange straightness to $-3.5/+9$ mm.
(Over 8' length)

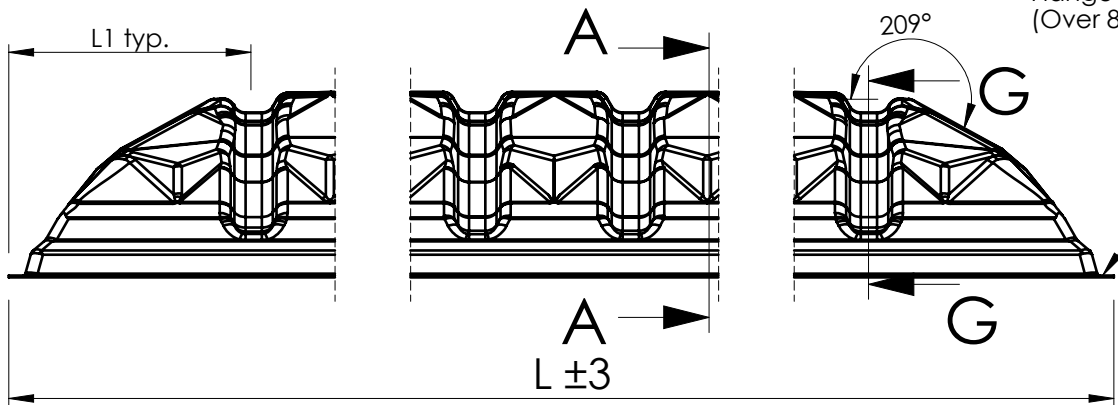
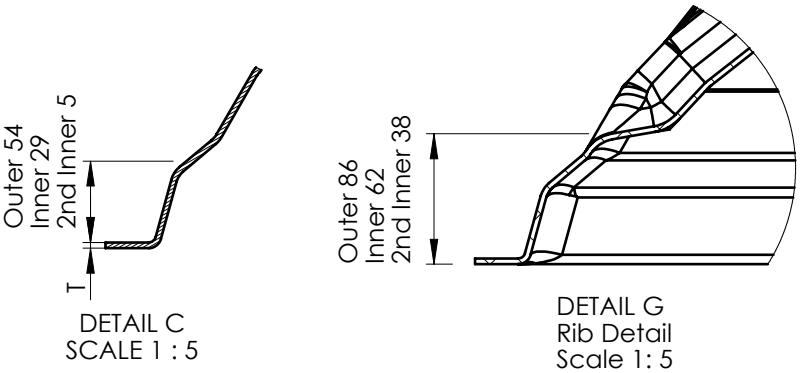

Flange flatness to ± 3.5 mm.

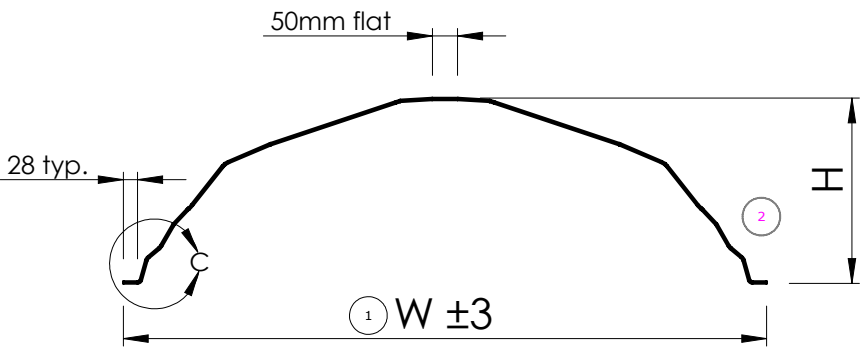

SECTION A-A

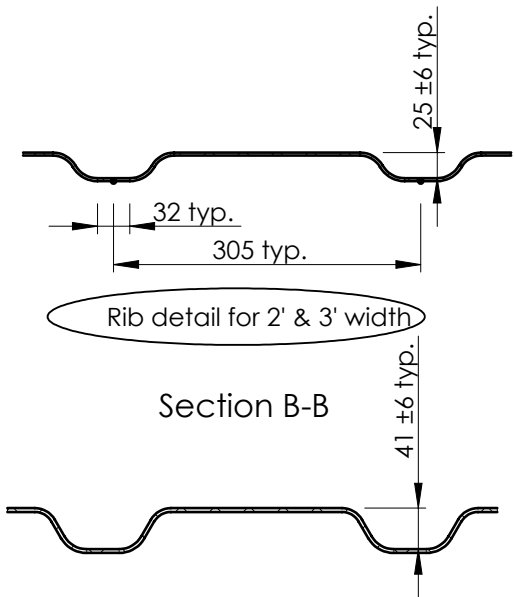

Rib detail for 2' & 3' width

Rib detail for 4', 5' & 6' width

Report #: F8970.01.01-109-44

Date: 08/18/2016

Verified by: *Richard H. Heston*

Size	L	W	H (Exterior dome)	H (Second dome)	H (Third dome)	L1
2'	667.5	667.5	182	156.5	131	486
3'	972	972	276	250.5	225	638
4'	1277	1277	368	342.5	317	486
5'	1582	1582	467	441.5	416	638
6'	1886.5	1886.5	555.5	530	504.5	790.5
7'	2191	-	-	-	-	-
8'	2496	-	-	-	-	-
10'	3106	-	-	-	-	-

Note: 1. 4'X8' dome shown
2. Height is based on the width dimension

Material			
Polycarbonate, or acrylic, or impact modified acrylic			
VELUX SKY-PRS 450 Old Brickyard Rd., Greenwood, South Carolina 29648			
Approvals TMA-A			
Checked by/drawn by/date /MM/29.03.2016			
Scale 1:15	Unspec. meas. mm	General tolerance ± 2	Size B

Specifications - generally			
Polycarbonate/Acrylic Alloy		309079.64	
Impact modified acrylic (Outer dome)		309209.64	
Impact modified acrylic (Inner dome)		309210.64	
Acrylic sheets for commercial		309052.64	
<u>CDx,CEx</u>			
Dome			
Product instructions no.			
Category			Operation Edition
21	303615	0A0	32 02

VELUX America Inc.
CONFIDENTIAL

Edition	Description of change	Date

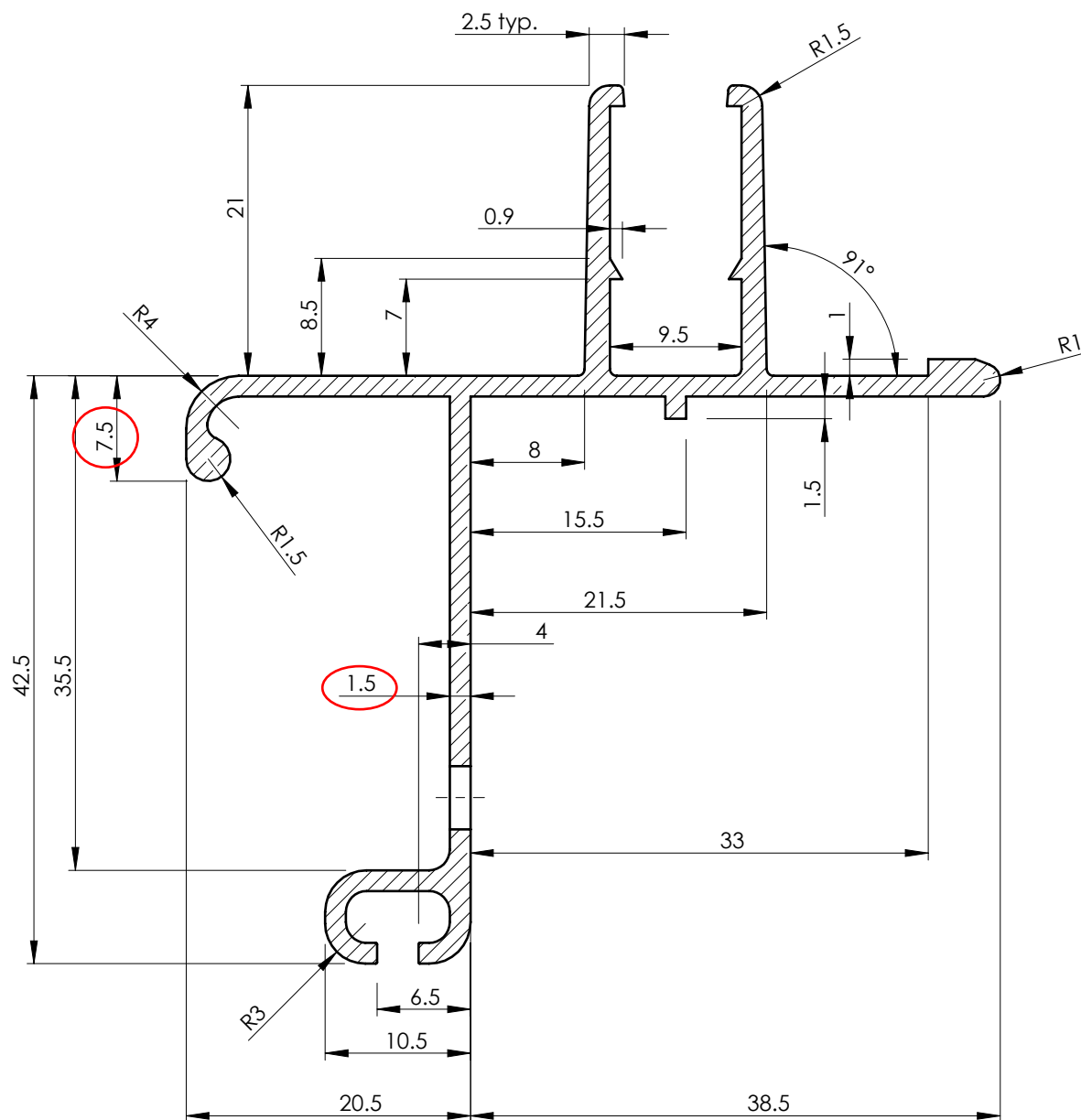

VELUX America Inc.
CONFIDENTIAL

Material				Specifications - generally				
6063/T5 Aluminum				Extruded Aluminum-Generally		309078.64		
VELUX SKY-PRS 450 Old Brickyard Rd., Greenwood, South Carolina 29648				<u>CDx,CEx,CTx,CGx,CHx,CJx</u>				
Approvals TMA-A				Inner frame Profile				
Checked by/drawn by/date /MM/20.01.2016				Product instructions no.				
Scale 2:1	Unspec. meas. mm	General tolerance ±0.5	Size B	Category 21	302359	000	00	01

Edition	Description of change	Date
02	Added CG2 sizes	3/22/16

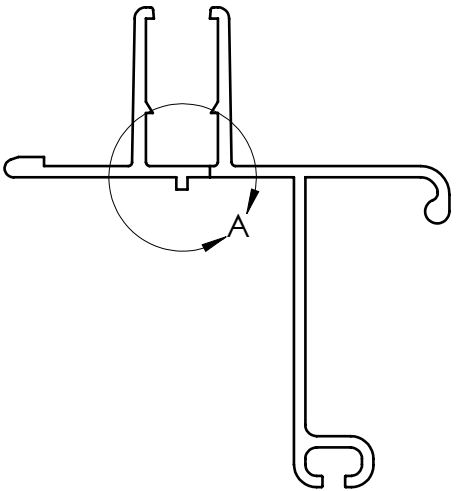
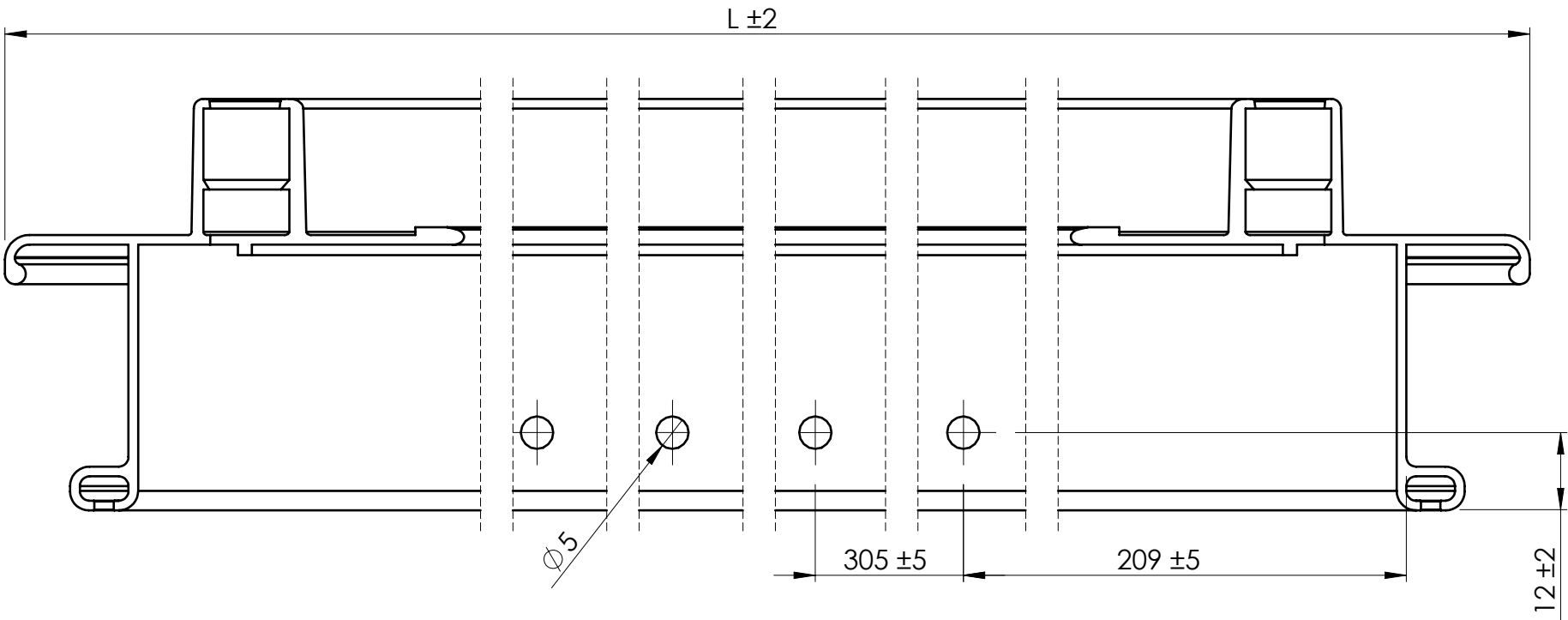
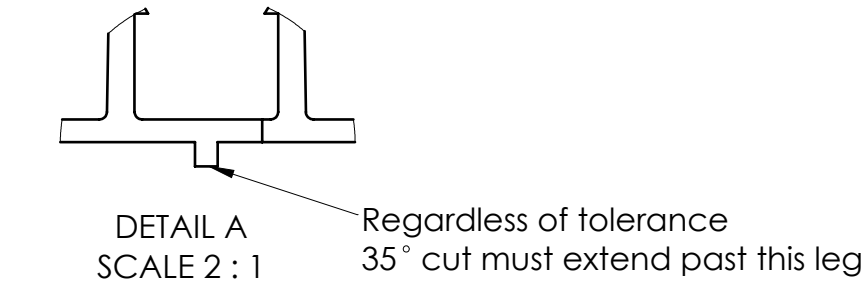
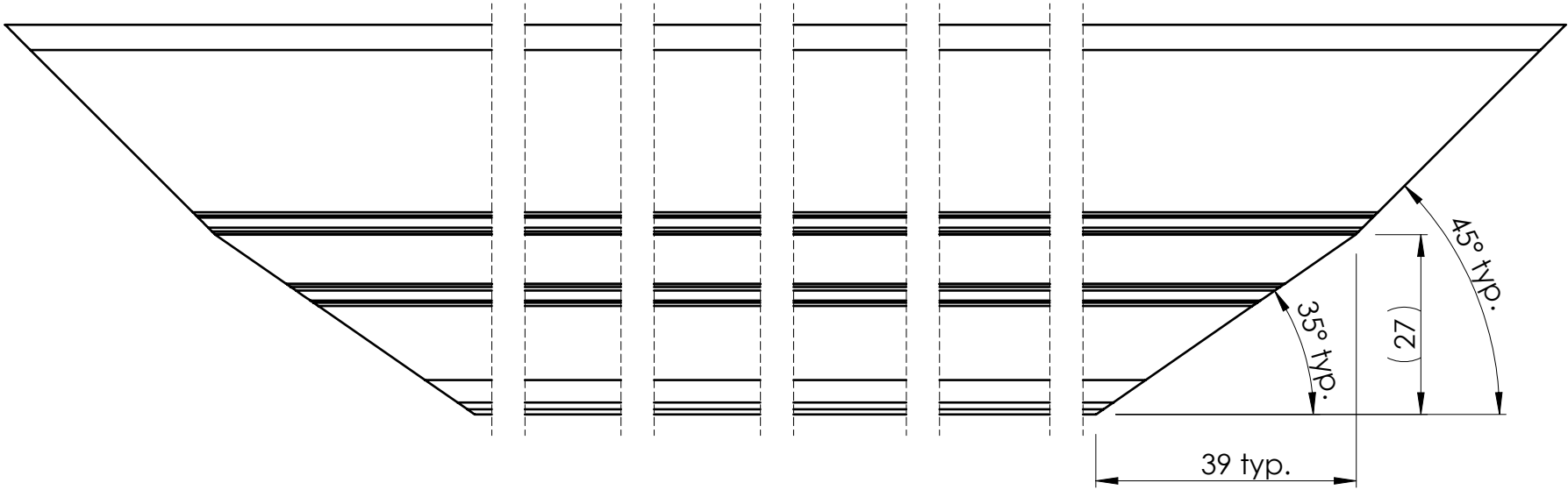

	Report #:	F8970.01.01-109-44
	Date:	08/18/2016
	Verified by:	

Size	L	Number of holes
2 foot	757	2
3 foot	1062	3
4 foot	1366	4
5 foot	1671	5
6 foot	1976	6
7 foot	2281	7
8 foot	2586	8
10 foot	3195	10
225	719	2
305	922	3
345	1024	3
465	1329	4

VELUX America Inc.
CONFIDENTIAL

VELUX SKY-PRS 450 Old Brickyard Rd., Greenwood, South Carolina 29648				CDx,CEx,CTx,CGx,CHx,CJx			
Approvals				Inner frame Cutting and punching			
Checked by/drawn by/date /REC/21.03.2016				Product instructions no.			
Scale 1:1	Unspec. meas. mm	General tolerance ±1	Size C	Category 21	302359	0A0	31 02



Report #:

F8970.01.01-109-44

Date:

08/18/2016

Verified by:



Edition	Description of change	Date
02	Added view "Detail D"	3/28/16

Size	L
2'	716
3'	1021
4'	1326
5'	1630
6'	1935
7'	2240
8'	2545
10'	3155
225	678
305	881
345	983
465	1288

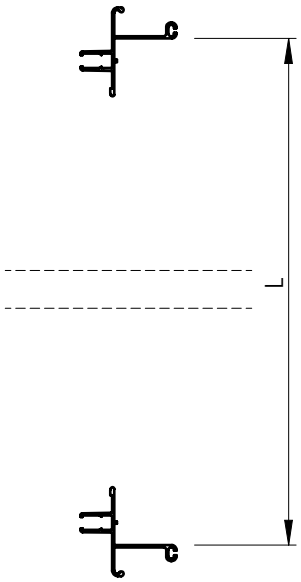

SECTION A-A

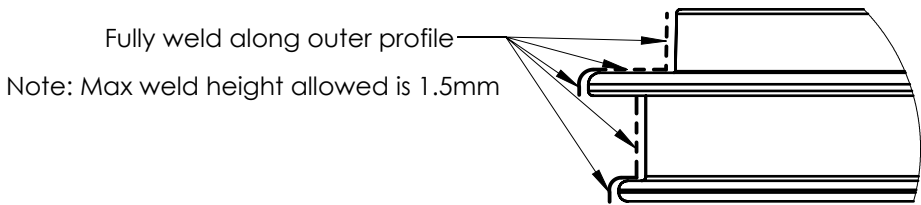
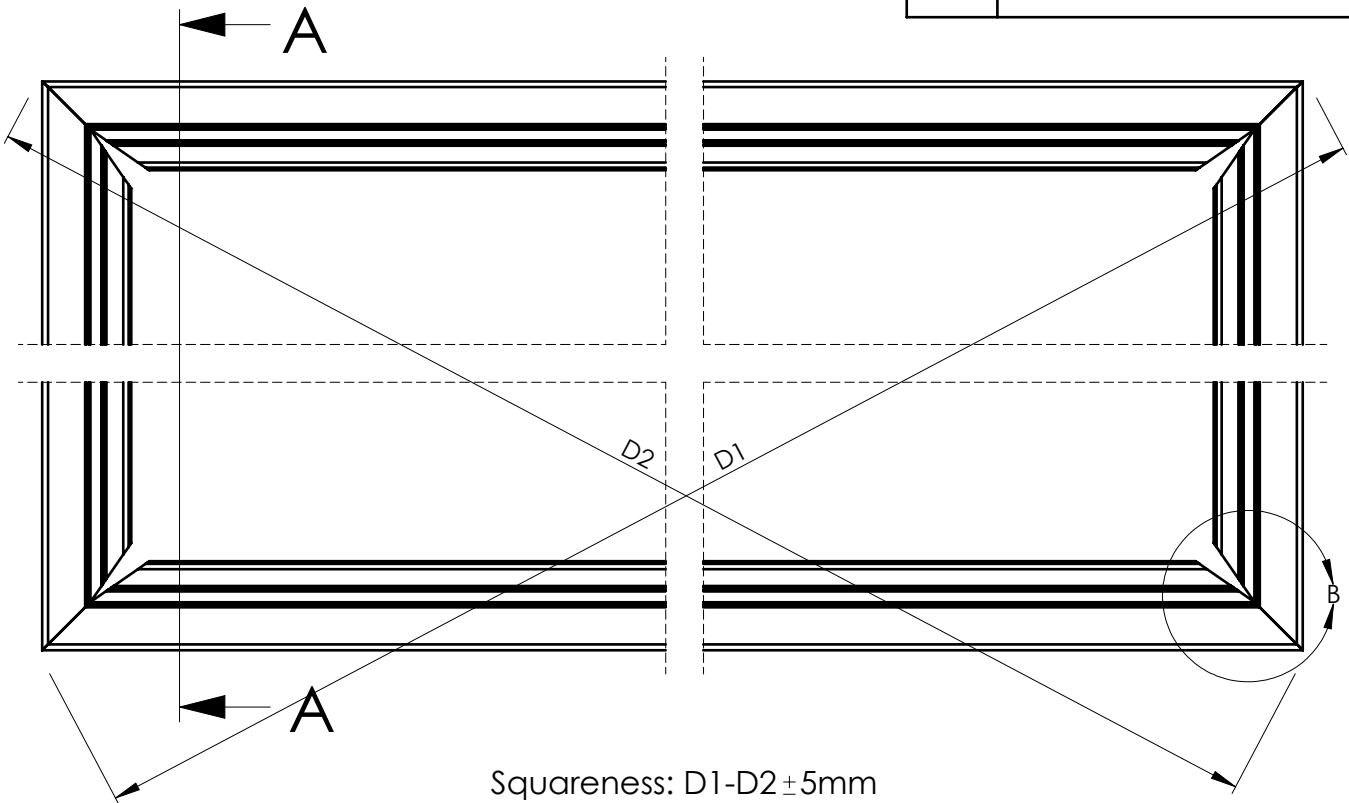

DETAIL C
SCALE 2 : 5

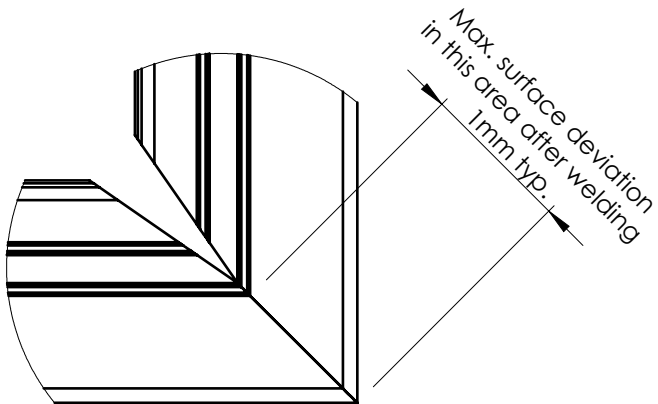
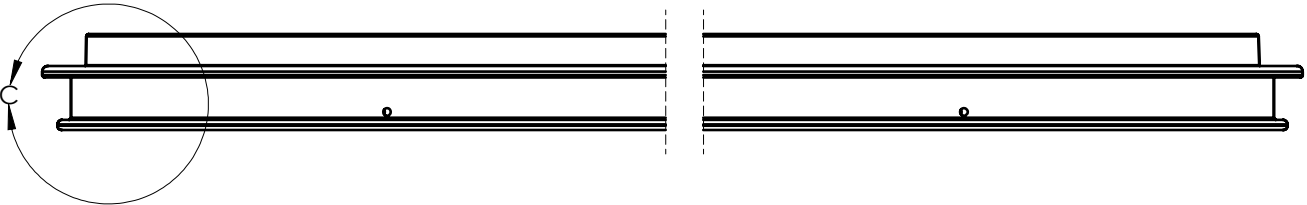

DETAIL B
SCALE 1 : 2

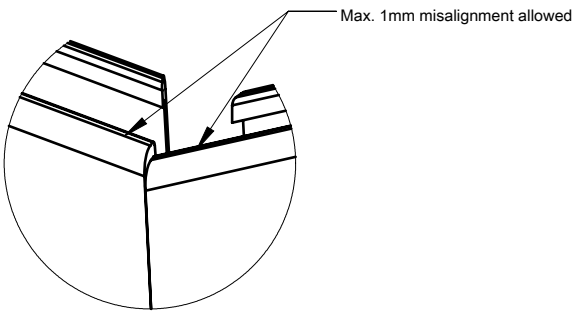

DETAIL D
SCALE 2 : 1

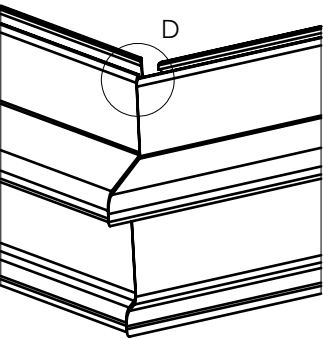

VELUX America Inc.
CONFIDENTIAL

VELUX SKY-PRS
450 Old Brickyard Rd., Greenwood, South Carolina 29648

Approvals

Checked by/drawn by/date
/RC/28.03.2016

Scale	Unspec. meas.	General tolerance	Size
1:5	mm	±2	B

CDx,CEx,CTx,CGx,CHx,CJx

Dome inner frame
Welding

Product instructions no.					Category	Operation	Edition
302359					21	0A0	42
							02



Edition	Description of change	Date

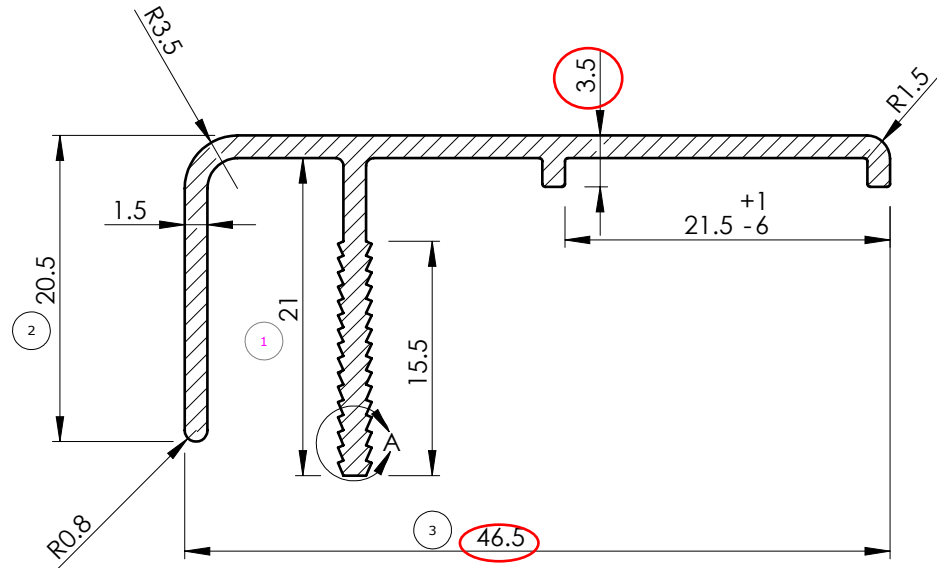

VELUX America Inc.
CONFIDENTIAL

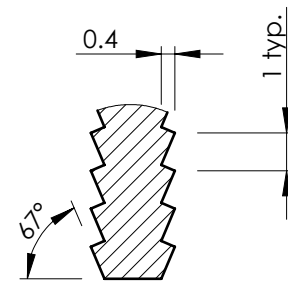

DETAIL A
SCALE 5 : 1

Notes:

1. Cross sectional area- 138 mm sq.
2. Break Corners- .38R
3. Purchased lineal length is 120"

Material				Specifications - generally				
6063/T5 Aluminum				Extruded Aluminum-Generally			309078.64	
<div>VELUX</div> <div>SKY-PRS</div> <div>450 Old Brickyard Rd., Greenwood, South Carolina 29648</div>				<div>CDx,CEx,CTx,CHx,CGx,CJx</div> <div>Dome clamp cover</div> <div>Profile</div>				
Approvals								
TMA-A								
Checked by/drawn by/date				Product instructions no.				
/MM/21.03.2016								
Scale	Unspec. meas.	General tolerance	Size	Category			Operation	Edition
2:1	mm	±.5	A	21	302361		000	00 01

Edition	Description of change	Date
02	Added CG2 sizes	3/22/16

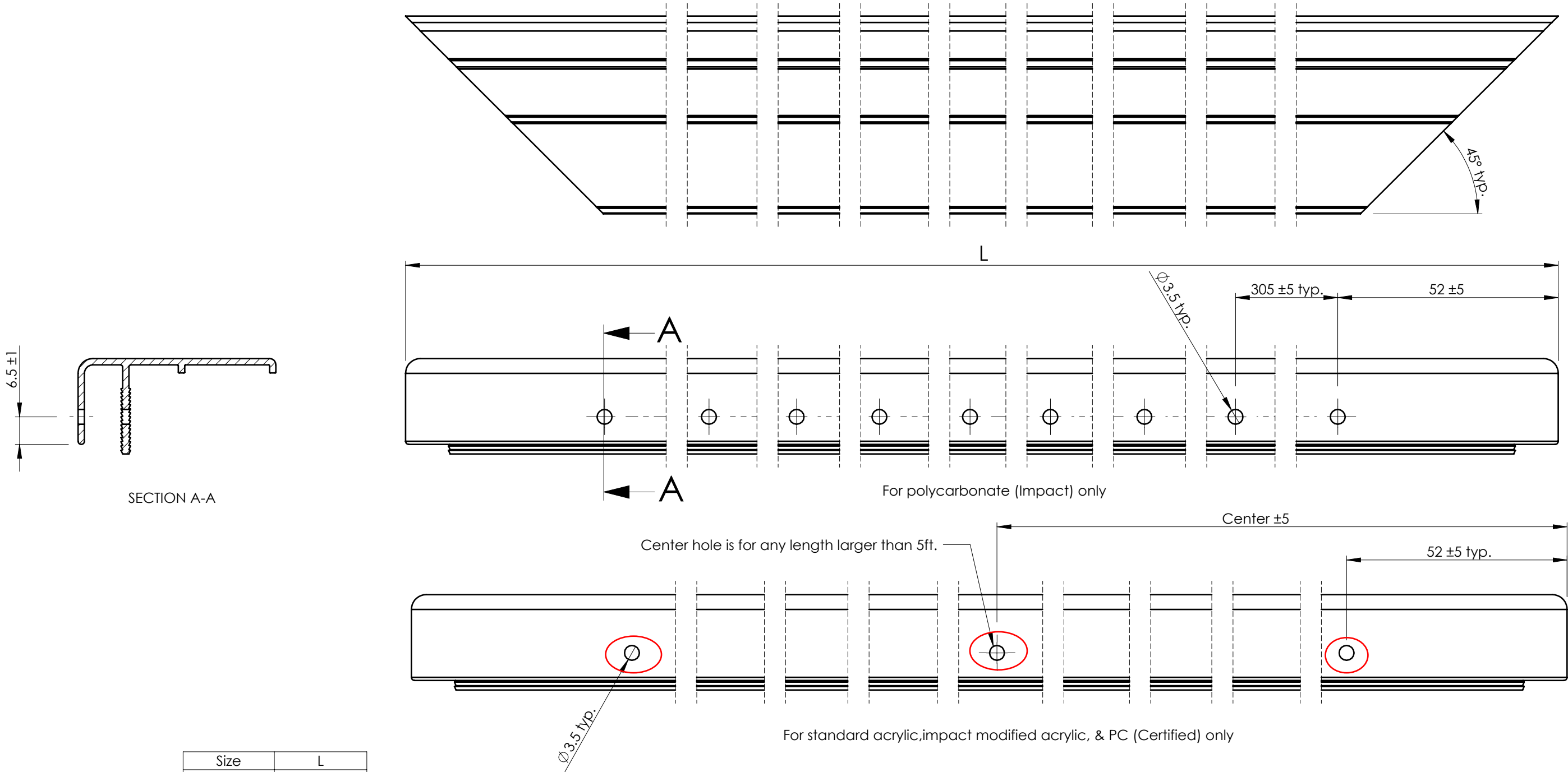

Size	L
2 foot	709
3 foot	1014
4 foot	1318
5 foot	1623
6 foot	1928
7 foot	2233
8 foot	2538
10 foot	3147
225	671
305	874
345	976
465	1281

VELUX America Inc.
CONFIDENTIAL

Note: 1. Cutting drawing is for both the dome clamp cover and the tall dome clamp cover.
2. Pre drilled 4mm hole goes through both legs of clamp cover.

VELUX SKY-PRS 450 Old Brickyard Rd., Greenwood, South Carolina 29648				CDx,CEx,CTx,CHx,CGx,CJx				
Approvals				Dome clamp cover Cutting and drilling				
Checked by/drawn by/date /RC/22.03.2016				Product instructions no.				
Scale 1:1	Unspec. meas. mm	General tolerance ±.5	Size B	Category 21	302361	0A0	31	02



Report #:

F8970.01.01-109-44

Date:

08/18/2016

Verified by:



Edition	Description of change	Date

Size	L
2'	709
3'	1014
4'	1319
5'	1623
6'	1928
7'	2233
8'	2538
10'	3148
225	734
305	937
345	1039
465	1344

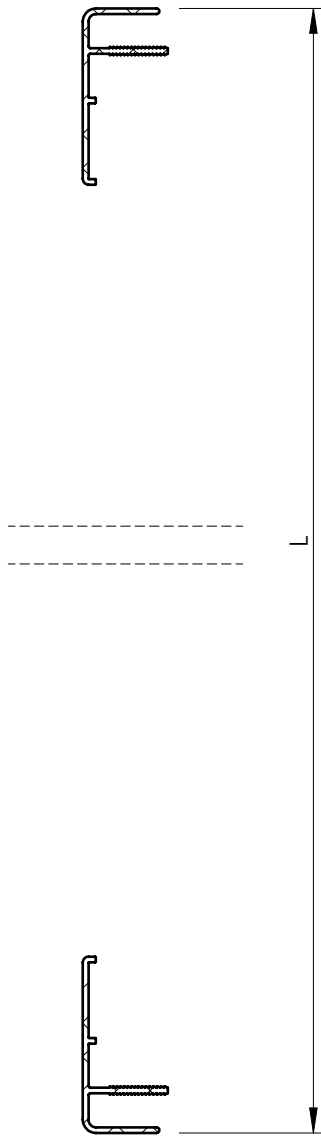

SECTION A-A

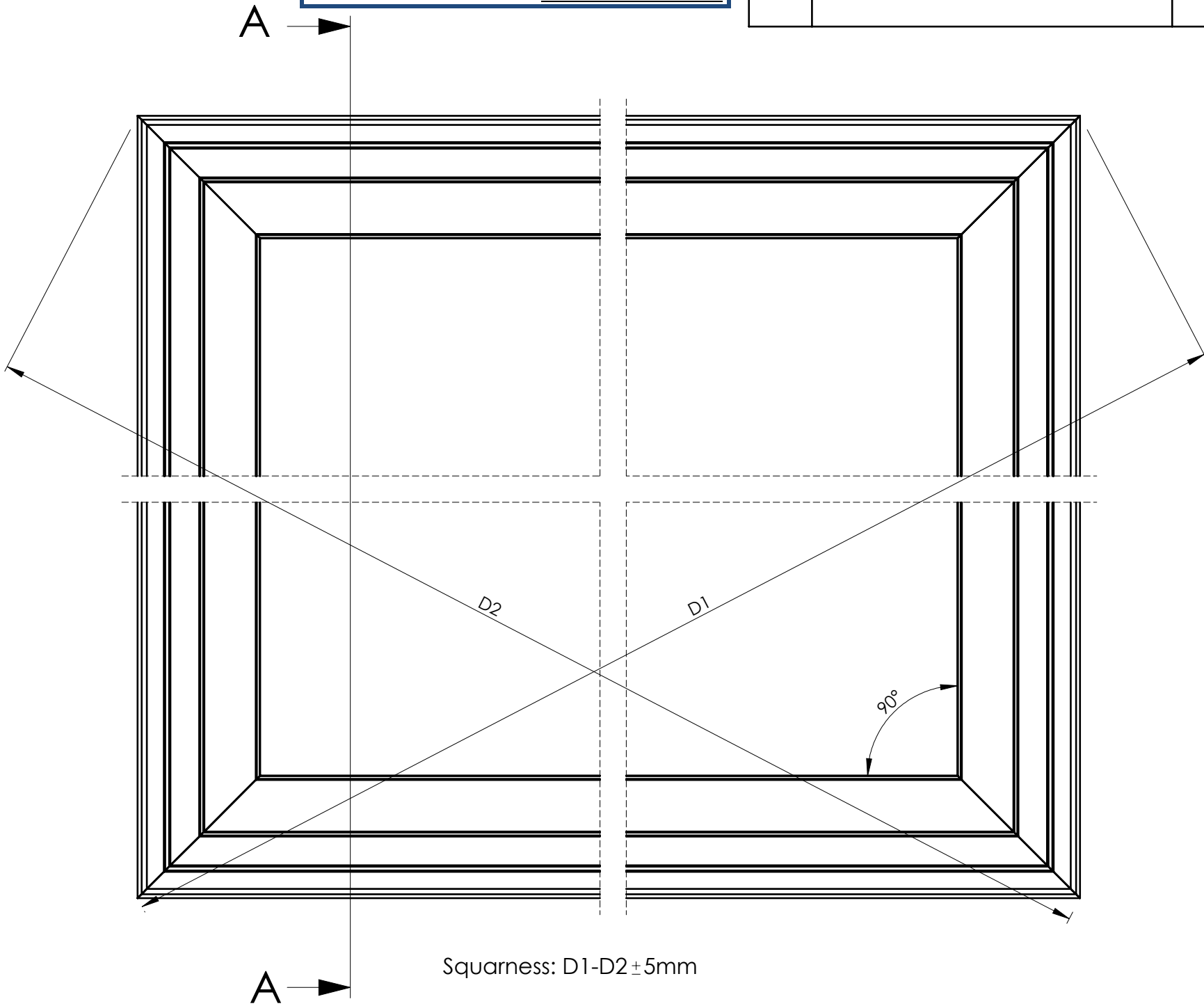

Squarness: D1-D2±5mm

Fully Weld along outer profile

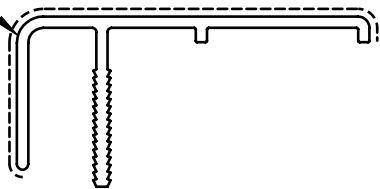

Scale 1:1

VELUX America Inc.
CONFIDENTIAL

Note: welding drawing is for both the dome clamp cover and the tall dome clamp cover

VELUX

SKY-PRS

450 Old Brickyard Rd., Greenwood, South Carolina 29648

Approvals

Checked by/drawn by/date
/MM/20.01.2016

Scale
1:2

Unspec. meas.
mm

General tolerance
±2

Size
B

CDx,CEx,CTx,CHx,CGx,CJx

Dome clamp cover
welding drawing

Product instructions no.

Category
21

302360

0A0

42

01



Report #: F8970.01.01-109-44

Date: 08/18/2016

Verified by: *Richard H. Heston*

Edition	Description of change	Date
02	Added note	3/29/16

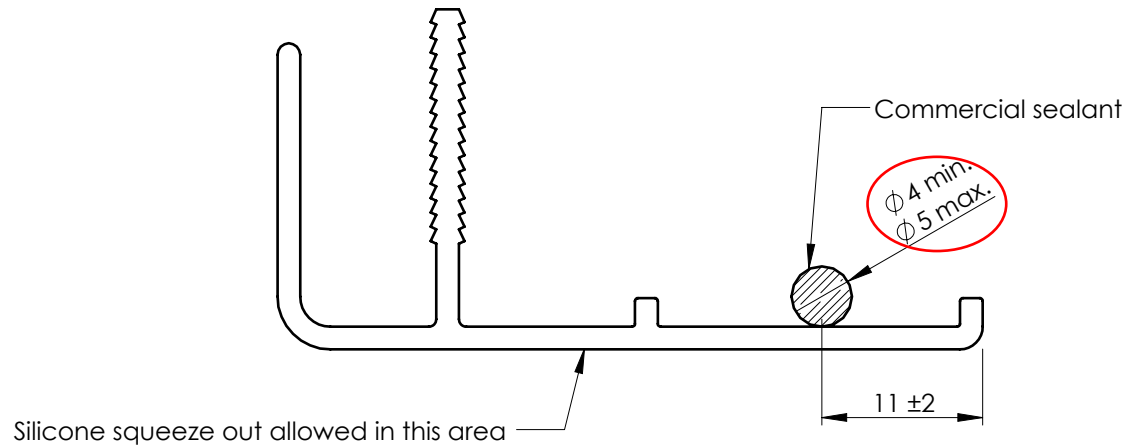

Notes:

Silicone bead shape is not important.

Min/Max diameter is used to determine total area.

No gaps in silicone allowed.

No squeeze out allowed on lens.

VELUX America Inc.
CONFIDENTIAL

VELUX**SKY-PRS**

450 Old Brickyard Rd., Greenwood, South Carolina 29648

Approvals

Checked by/drawn by/date
/MM/29.03.2016

Scale

2:1

Unspec. meas.

mm

General tolerance

±1

Size

A

Specifications - generally

Silicone for commercial application

309213.64

CDx, CEx, CTx, CHx, CGx, CJx

Clamp Frame

Silicone placement

Product instructions no.

Category

21

303660

0A0

Operation

52

Edition

02



Edition	Description of change	Date

Measure	Tol.
< 2.5	0.35
2.5–4	0.4
4–6.3	0.5
6.3–10	0.7
10–16	0.8
16–54	1

Angles $\pm 1^\circ$

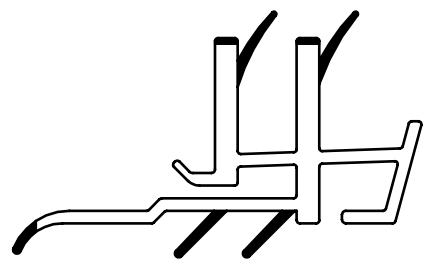

Scale 1:1

☐ 103-50D

64A

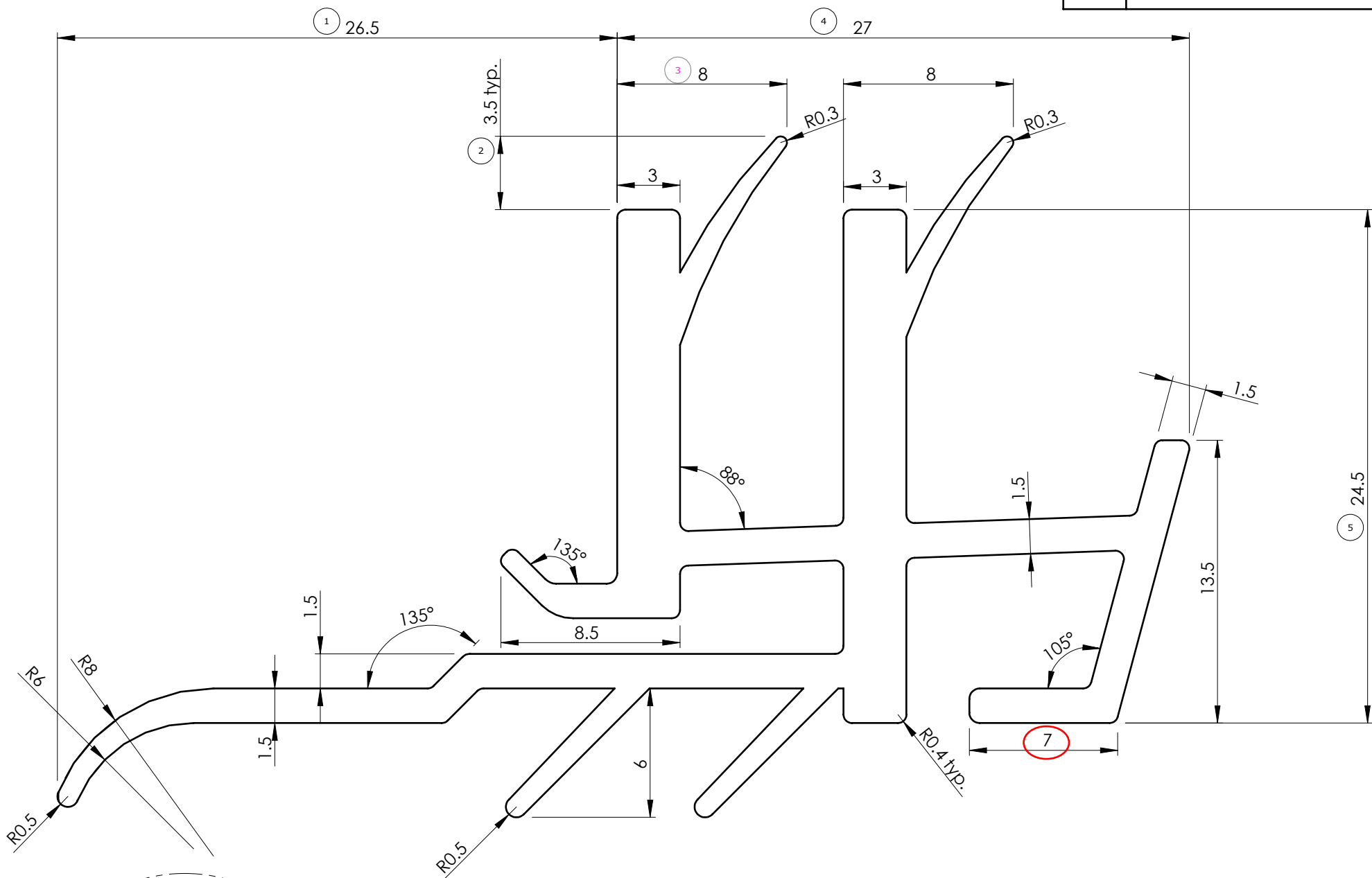

VELUX America Inc.
CONFIDENTIAL

Notes:
1. Cross sectional area- 300.7 mm sq.
2. Purchased lineal length is 120"

Material				Specifications - generally					
TPE Color: Black				TPE for Gaskets			309034.64		
<div>VELUX</div> <div>SKY-PRS</div> <div>450 Old Brickyard Rd., Greenwood, South Carolina 29648</div>				<div>CDx,CEx,CTx,CGx,CHx,CJx</div> <div>High profile gasket</div>					
Approvals TMA-A									
Checked by/drawn by/date /MM/25.01.2016									
Scale 4:1	Unspec. meas. mm	General tolerance See chart	Size B	Category 21	Product instructions no. 303612		000	Operation 00	Edition 01

Edition	Description of change	Date

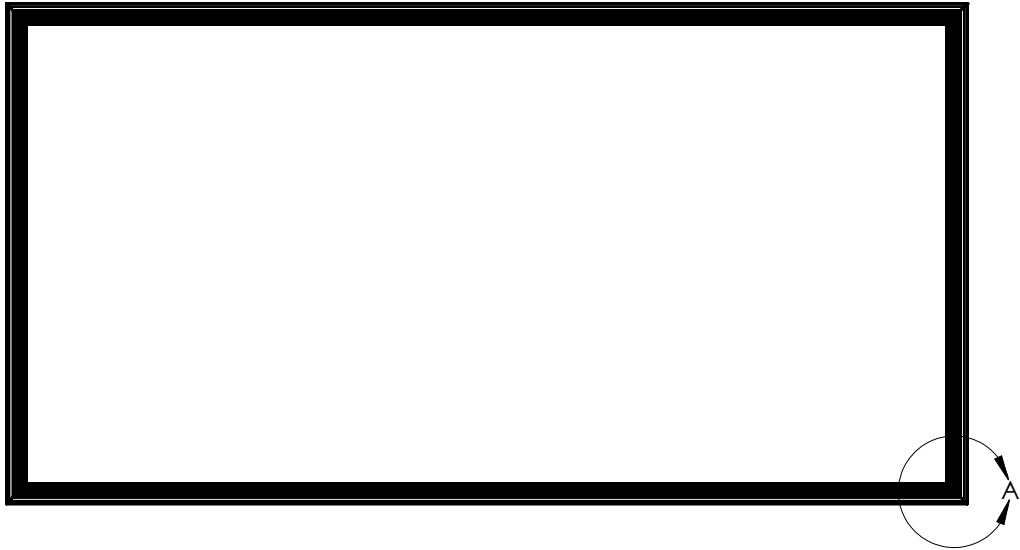

Snip corner as shown

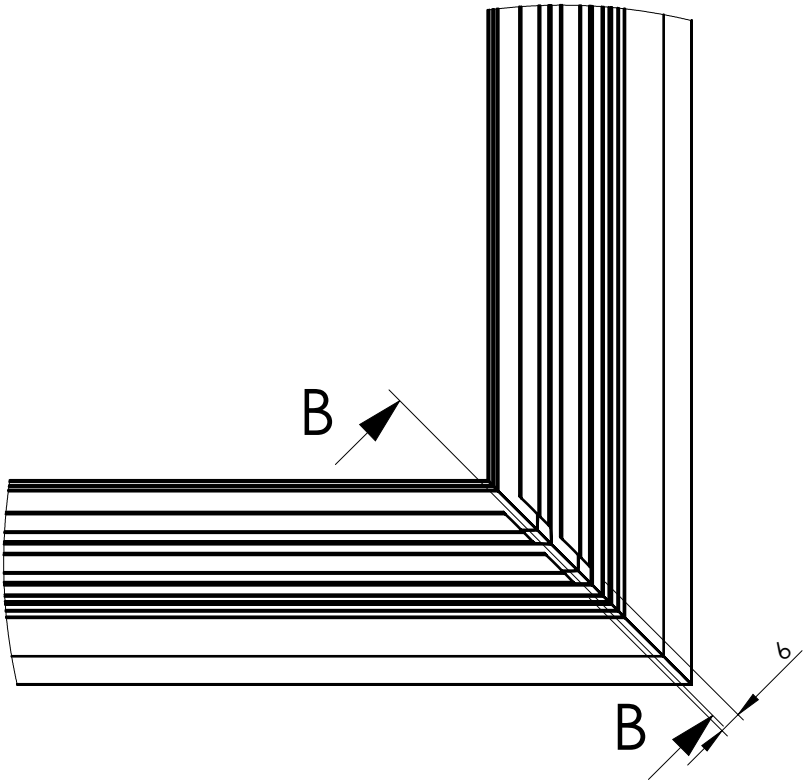

DETAIL A
SCALE 1 : 2

Max 1mm flashing allowed in this area

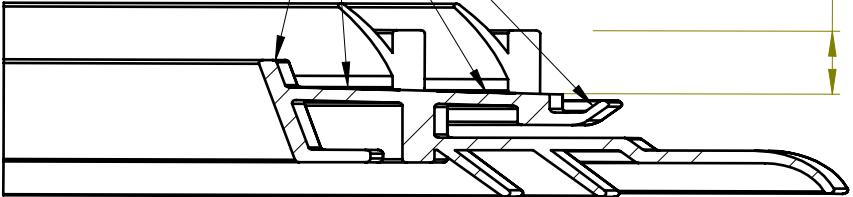

SECTION B-B
SCALE 1 : 1

Depth of condensation groove
Max. 9
Min. 8

Report #:

F8970.01.01-109-44

Date:

08/18/2016

Verified by:

VELUX America Inc.
CONFIDENTIAL

VELUX SKY-PRS 450 Old Brickyard Rd., Greenwood, South Carolina 29648				CDx,CEx,CTx,CGx,CHx,CJx			
Approvals				Gasket groove cutting			
Checked by/drawn by/date /MM/20.01.2016				Product instructions no.			
Scale 1:20	Unspec. meas. mm	General tolerance ±0.5	Size B	Category 21	303611	000	39 01

Edition	Description of change	Date
02	Corrected 1/2 sizes L & L2 dimensions	3/29/16

Size	L	L2
2'	659	713
3'	964	1017
4'	1268	1322
5'	1573	1627
6'	1878	1932
7'	2183	2237
8'	2488	2541
10'	3097	3151
225	621	675
305	824	878
345	926	980
465	1231	1285

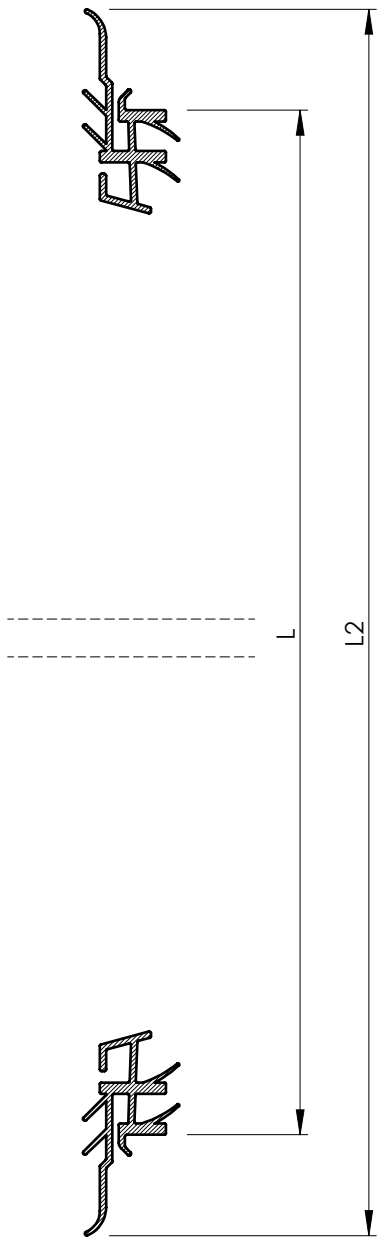

SECTION A-A

Max. surface deviation
in this area after welding
1mm typ.

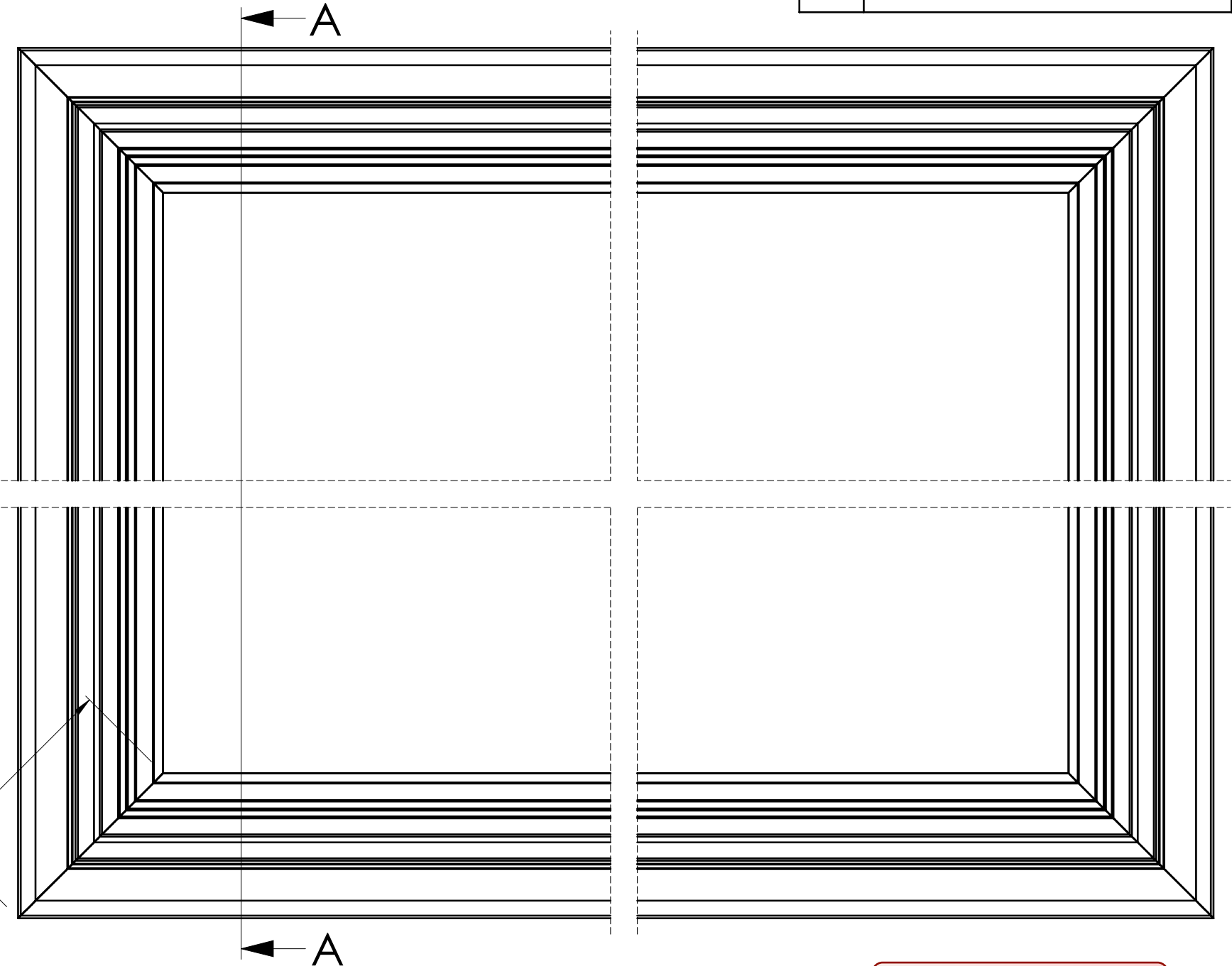

Max. 2mm flashing allowed in this area

Max. 1mm flashing allowed in this area

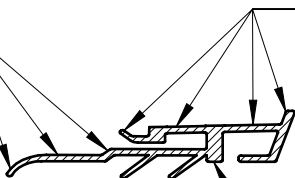

Max. 1mm flashing allowed in this area

All other areas 3mm flashing allowed

	Report #:	F8970.01.01-109-44
	Date:	08/18/2016
	Verified by:	

VELUX SKY-PRS
450 Old Brickyard Rd., Greenwood, South Carolina 29648

Approvals

Checked by/drawn by/date
/RC/29.03.2016

Scale	Unspec. meas.	General tolerance	Size
1:2	mm	±2	B

CDx,CEx,CTx,CGx,CHx,CJx

Gasket welding

Product instructions no.					Operation	Edition
Category	21	303611	0A0	42	02	

VELUX America Inc.
CONFIDENTIAL

Edition	Description of change	Date
02	Revised material description	3/29/16

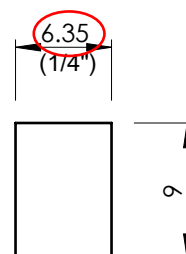
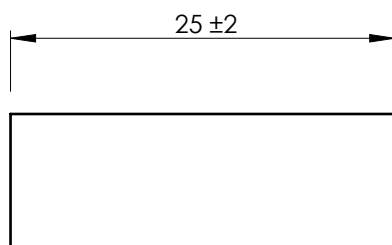

	Report #:	F8970.01.01-109-44
	Date:	08/18/2016
	Verified by:	<i>Richard Hartman</i>

VELUX America Inc.
CONFIDENTIAL

Material				Specifications - generally				
Wool felt for wicking (grey)				Foam gasket wick mat'l commercial domes		309212.64		
VELUX SKY-PRS 450 Old Brickyard Rd., Greenwood, South Carolina 29648				<u>CDx,CEx,CTx,CGx,CHx,CJx</u>				
Approvals TMA-B				Gasket wick				
Profile/cutting								
Checked by/drawn by/date /MM/29.03.2016				Product instructions no.				
Scale 2:1	Unspec. meas. mm	General tolerance ±1	Size A	Category 21	305659	000	Operation 00	Edition 02

Edition	Description of change	Date
02	Added note	3/29/16

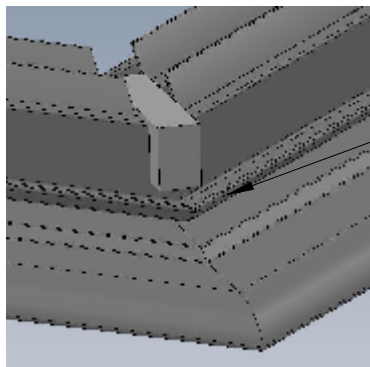

Wick must not extend
beyond this surface

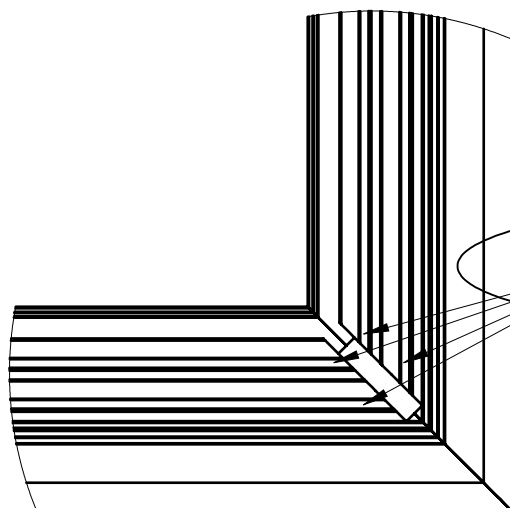

Wick must contact all 4 posts

DETAIL A
SCALE 1 : 2

Place wicks in all four corners

	Report #:	F8970.01.01-109-44
	Date:	08/18/2016
	Verified by:	<i>Richard H. Hinton</i>

VELUX America Inc.
CONFIDENTIAL

VELUX

SKY-PRS

450 Old Brickyard Rd., Greenwood, South Carolina 29648

Approvals

Checked by/drawn by/date
/MM/29.03.2016

Scale
1:10

Unspec. meas.
mm

General tolerance
±1

Size
A

CDx, CEx, CTx, CGx, CHx, CJx

Gasket

Wick placement

Product instructions no.

Category

21

305659

0A0

Operation

52

Edition

02

Intertek



Report #: F8970.01.01-109-44

Date: 08/18/2016

Verified by: *Tobias Hultman*

Edition

Description of change

Date

T25 drive

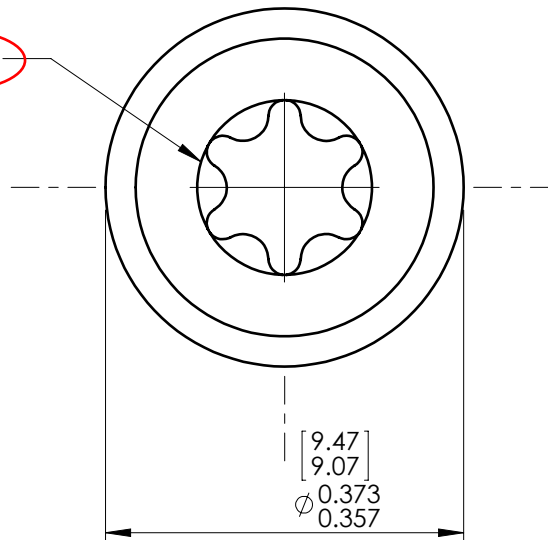

#10 screw size

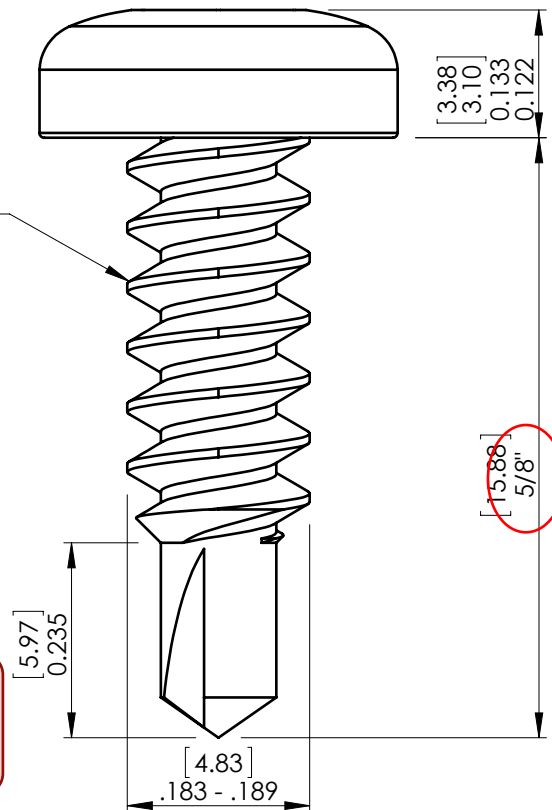

VELUX America Inc.
CONFIDENTIAL

Material				Specifications - generally					
Torx Pan head, SST, #2 drill point #10-16x5/8"				Stainless steel screws		414010.64			
<div>VELUX</div> <div>SKY-PRS</div> <div>450 Old Brickyard Rd., Greenwood, South Carolina 29648</div>				<div>CDx, CEx, CTx, CGx, CHx, CJx</div> <div>Torx screw</div>					
Approvals									
TMA-A									
Checked by/drawn by/date					Product instructions no.				
/MM/20.01.2016									
Scale	Unspec. meas.	General tolerance	Size	Category			Operation	Edition	
5:1	Inches	±.015	A	21	306225		000	00	01