

ELEVATION

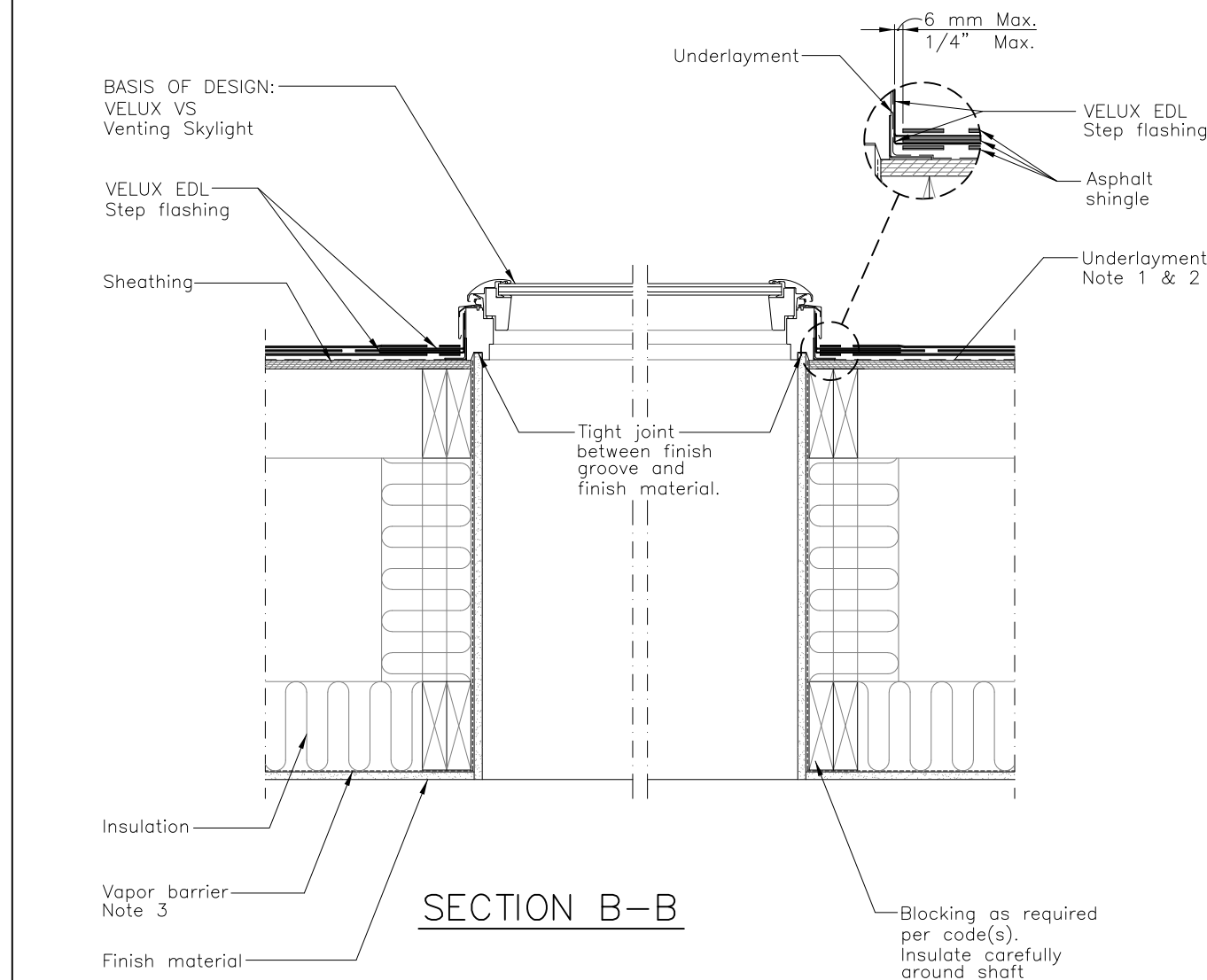

SECTION B-B

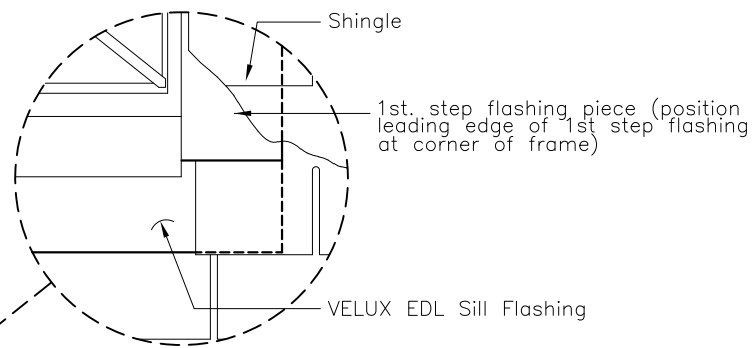
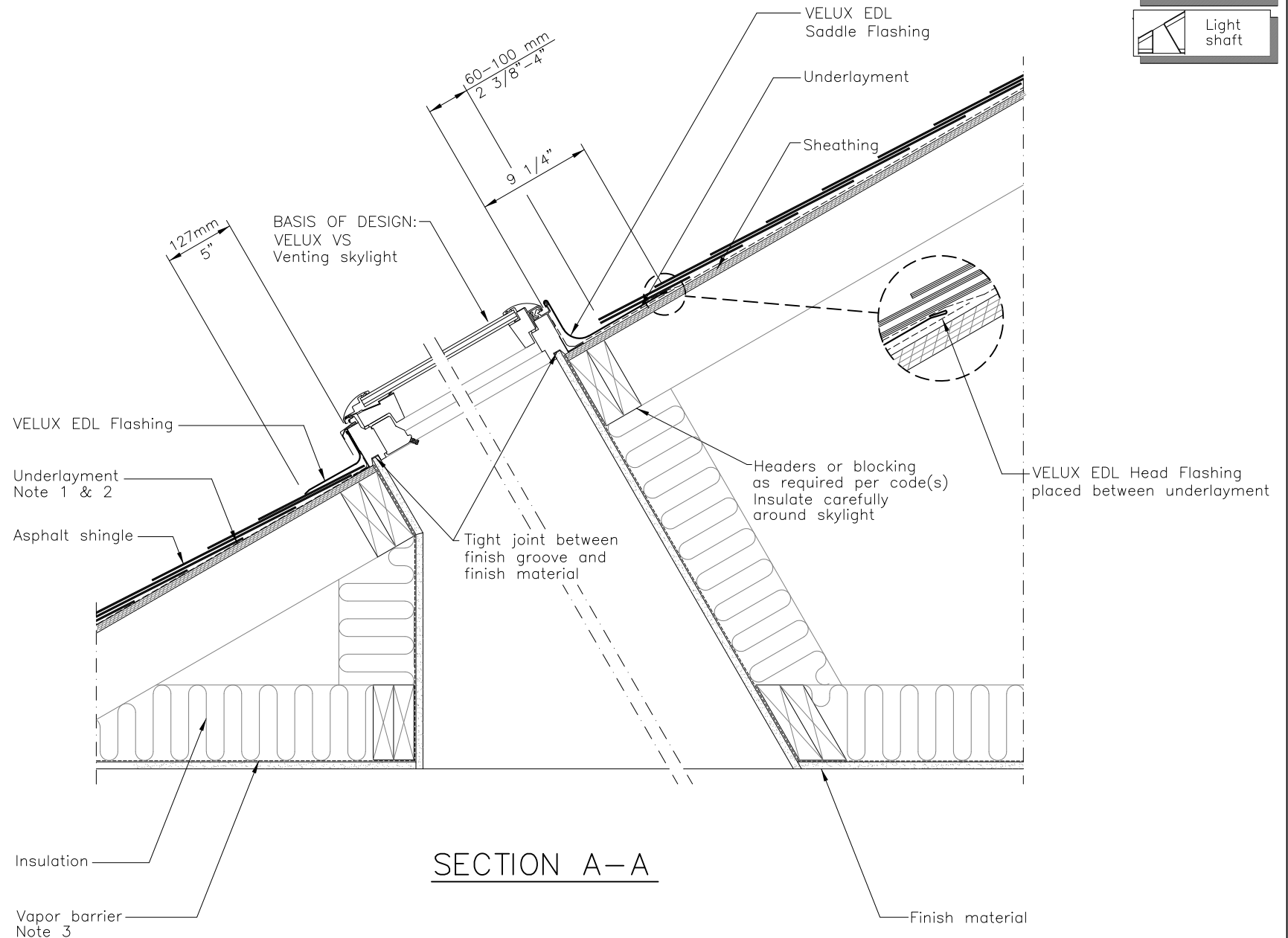

SECTION A-A

	VS
	EDL
	Asphalt shingles
	Light shaft

GENERAL NOTES

1. Wrap frame in ZOZ 216 adhesive underlayment included with VELUX flashing.
2. Underlayment to be folded up against all sides of skylight.
3. Vapor barrier should be used to avoid moisture.

 Sky-Product Management	VELUX 1418 Evans Pond Road Greenwood, SC 29649 1-800-88-VELUX www.VELUXUSA.com	<table border="1"> <tr> <th>Name</th> <th>Date</th> </tr> <tr> <td>JDH</td> <td>July 2020</td> </tr> <tr> <td>JL, WQ</td> <td>July 2020</td> </tr> </table>	Name	Date	JDH	July 2020	JL, WQ	July 2020
	Name	Date						
JDH	July 2020							
JL, WQ	July 2020							
VS-Residential/Commercial Roof Section (Light Shaft and Asphalt Shingles)		Drawing No.  VS-02-0720						

This drawing is an instrument of service and is provided for informational use only.