

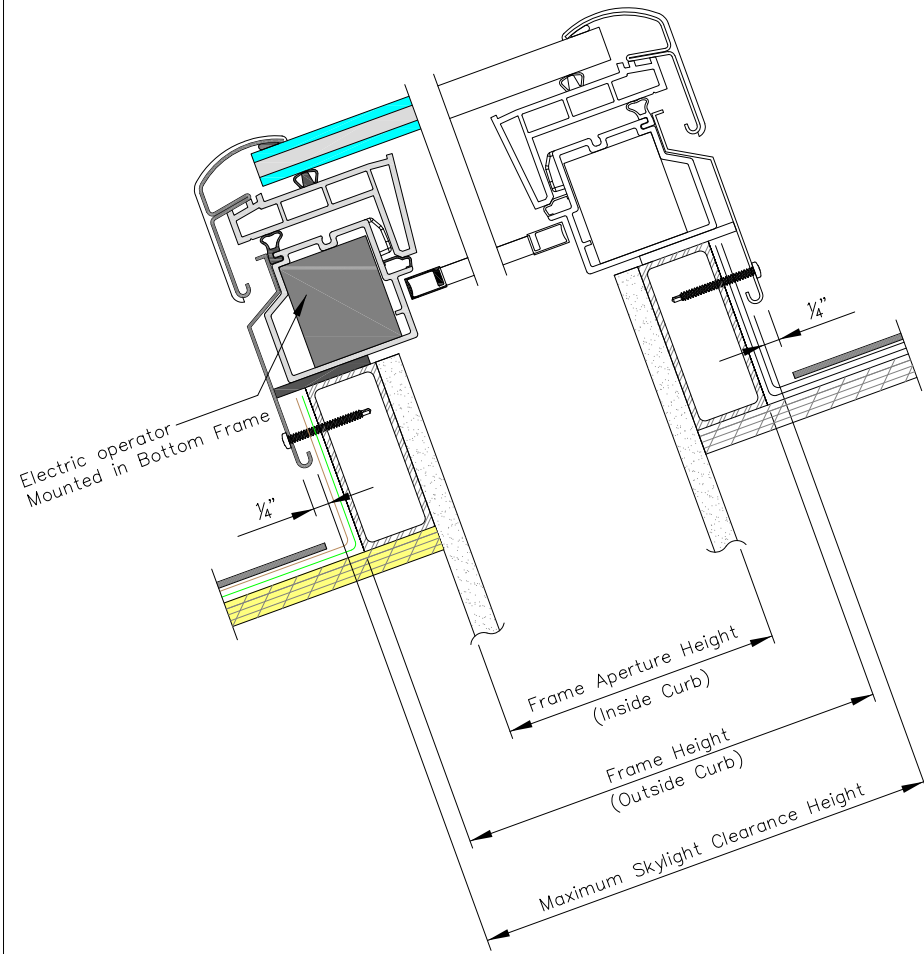

0:12 - 20:12

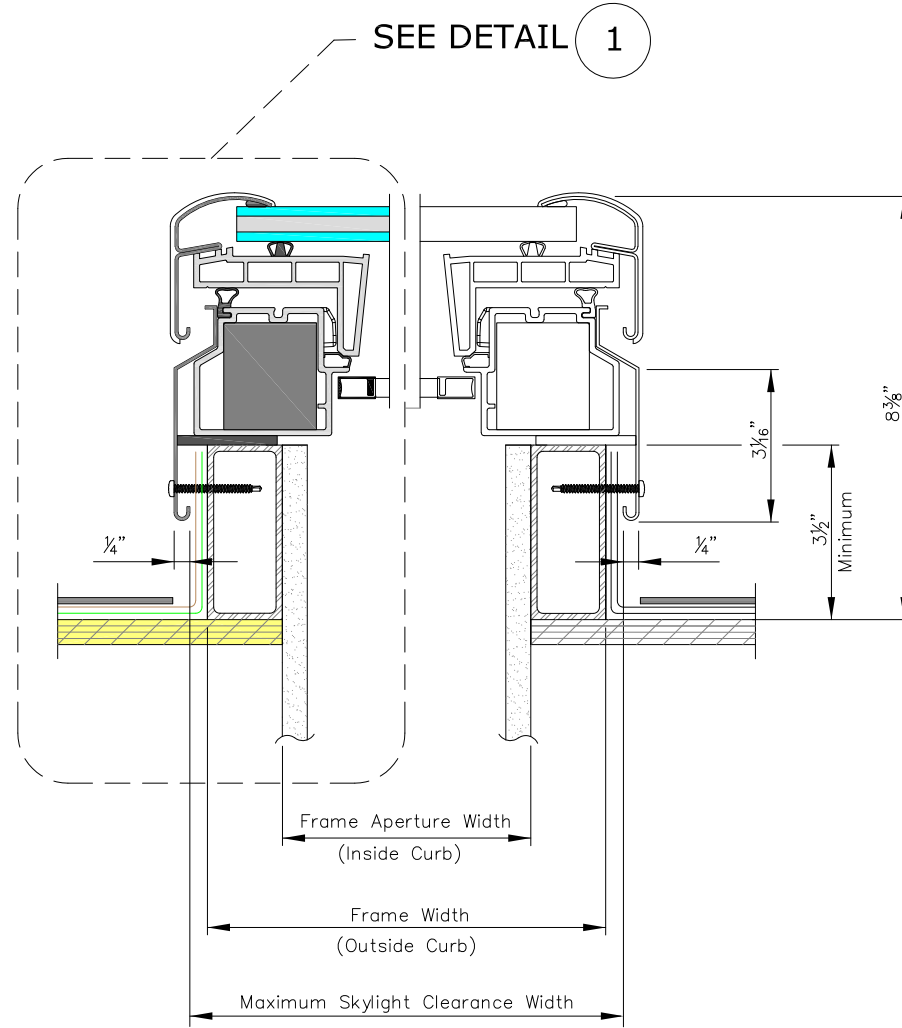

VERTICAL CROSS SECTION



HORIZONTAL CROSS SECTION

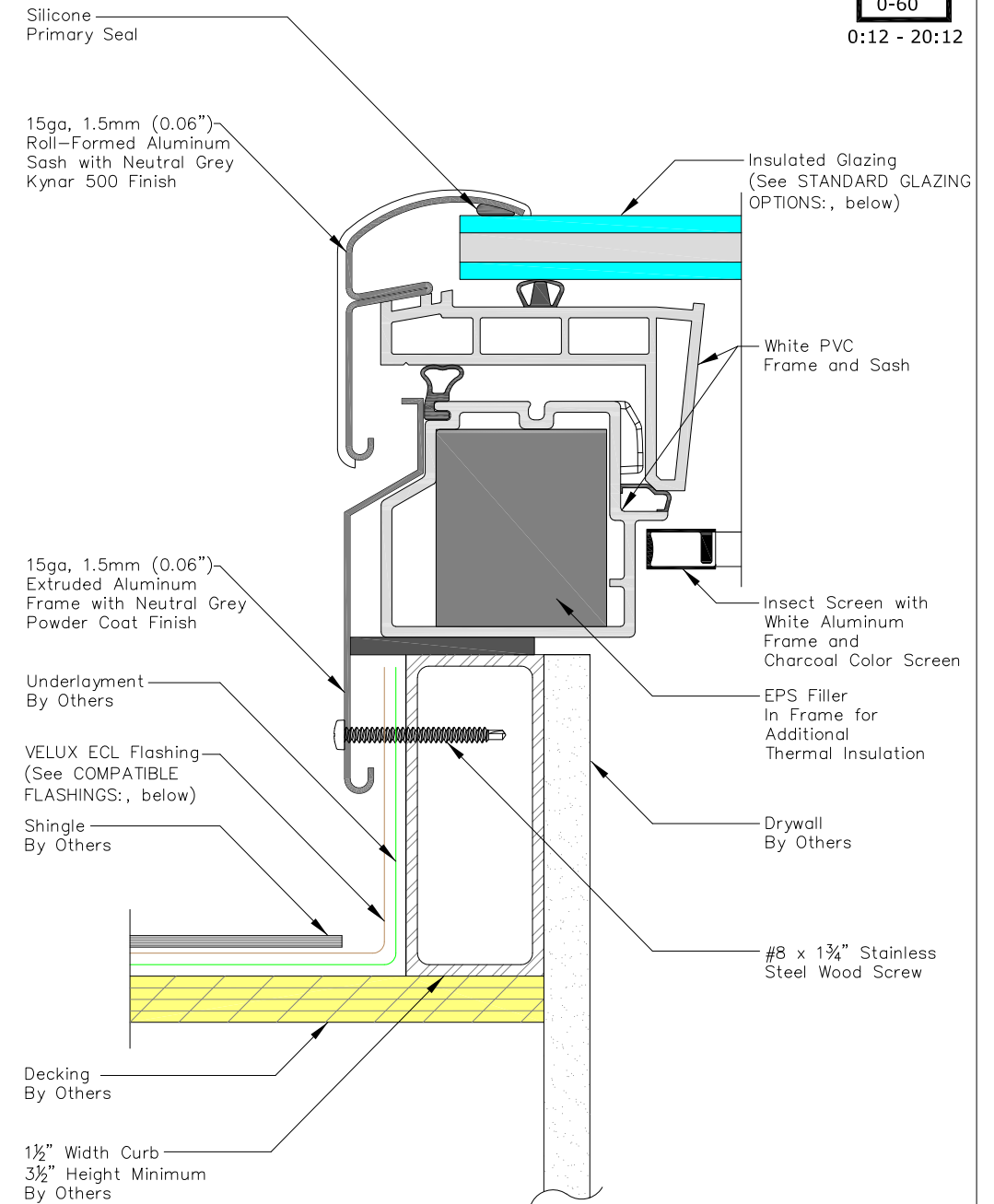

DETAIL 1

PRODUCT DIMENSIONS

METRIC UNITS (MILLIMETERS)								IMPERIAL UNITS (INCHES)							
Size	Frame Width	Frame Aperture Width	Maximum Skylight Clearance Width	Frame Height	Frame Aperture Height	Maximum Skylight Clearance Height	Daylight Area* (Sq. Meters)	Size	Frame Width	Frame Aperture Width	Maximum Skylight Clearance Width	Frame Height	Frame Aperture Height	Maximum Skylight Clearance Height	Daylight Area* (Sq. Feet)
2222	648	572	675.3	648	572	675.3	0.24	2222	25 1/2	22 1/2	26 9/16	25 1/2	22 1/2	26 9/16	2.58
2234	648	572	675.3	952	876	980	0.39	2234	25 1/2	22 1/2	26 9/16	37 1/2	34 1/2	38 9/16	4.20
2246	648	572	675.3	1257	1181	1284.8	0.55	2246	25 1/2	22 1/2	26 9/16	49 1/2	46 1/2	50 9/16	5.92
3030	851	775	878.4	851	775	878.4	0.49	3030	33 1/2	30 1/2	34 9/16	33 1/2	30 1/2	34 9/16	5.27
3046	851	775	878.4	1257	1181	1284.8	0.77	3046	33 1/2	30 1/2	34 9/16	49 1/2	46 1/2	50 9/16	8.29
3434	952	876	980	952	876	980	0.64	3434	37 1/2	34 1/2	38 9/16	37 1/2	34 1/2	38 9/16	6.89
4646	1257	1181	1284.8	1257	1181	1284.8	1.22	4646	49 1/2	46 1/2	50 9/16	49 1/2	46 1/2	50 9/16	13.13

- STANDARD GLAZING OPTIONS:**
- Laminated LowE3 (04)
 - Impact (06)
 - White Laminated (08)
- *Tempered Exterior Pane used with all options

- COMPATIBLE FLASHINGS:**
- ECL Step flashing
 - ECW Tile flashing

- ELECTRICAL/CONTROL DATA:**
- VCE Skylight controlled via 2.4 GHz radio frequency KLR 200 remote control provided with skylight. Optional controls for VCE Skylight are KLI 110 Wall Mounted Keypad or KLF 100 Home Automation Integration Kit.
 - Electrical Operator 100-240V, 50-60 HZ, 18 WATTS

NOTES:
1. Max sash opening is 11" by stainless steel chain.

This drawing is an instrument of service and is provided for informational use only.



Sky-Global Product Management

VELUX
1418 Evans Pond Road
Greenwood, SC 29649
1-800-88-VELUX
www.VELUXUSA.com

VCE - Electric Venting Curb Mounted Skylight